



# Ultra Thin Micathermic Heater with Remote Control

OWNER'S MANUAL  
Model # HM1-10R-32



**PLEASE SAVE THESE INSTRUCTIONS**

**WARNING: READ THIS OWNER'S MANUAL CAREFULLY BEFORE USE.**

# FLAT PANEL MICATHERMIC HEATER w/ REMOTE CONTROL

Thank you for choosing a Soleus Air heater. This owner's manual will provide you with valuable information necessary for the proper care and maintenance of your new product. Please take a few moments to thoroughly read the instructions and familiarize yourself with all the operational aspects of your new heater.

For your own records, please attach a copy of your sales receipt to this manual. Also, write the store name/location, date purchased, and serial number below:

Store Name: \_\_\_\_\_

Location: \_\_\_\_\_

Date Purchased: \_\_\_\_\_

Serial Number (located on back of unit): \_\_\_\_\_

## IMPORTANT INSTRUCTIONS

When using this electric unit, basic safety precautions should always be followed to reduce the risk of fire, electric shock, and injury to persons, including the following:

1. Read ALL instructions before using this unit.
2. CAUTION: Risk of Electric Shock. DO NOT open or try to repair the heater yourself.
3. This heater may get hot when in use. To avoid burns, DO NOT let bare skin touch hot surfaces. If provided, use handles when moving this heater.
4. Keep combustible materials, such as furniture, pillows, bedding, paper, clothes, and curtains at least 3 ft from the front of the heater and keep them away from the sides, top, and rear. DO NOT place towels or other objects on the heater.
5. Extreme caution is necessary when any heater is used by or near children or the disabled, or when the heater is left operating and unattended.
6. DO NOT operate any heater with a damaged cord or after the heater malfunctions, has been dropped or damaged in any manner. Return heater to authorized service facility for examination, electrical or mechanical adjustment, or repair.
7. This heater is not intended for use in bathrooms, laundry areas and similar indoor locations. NEVER locate heater where it may fall into a bathtub or other water container. To protect against electrical hazards, DO NOT immerse in water or other liquids.
8. DO NOT touch the control panel or plug with a wet hand.
9. DO NOT run cord under carpeting. DO NOT cover cord with throw rugs, runners, or similar coverings. Arrange cord away from traffic area and where it will not be tripped over.
10. DO NOT insert or allow foreign objects to enter any ventilation or exhaust opening as this may cause an electric shock or fire, or damage the heater.
11. To prevent a possible fire, DO NOT block the air intakes or exhaust in any manner. DO

NOT use on soft surfaces, like a bed, where openings may become blocked.

12. A heater has hot and arcing or sparking parts inside. DO NOT use in areas where gasoline, paint, explosive and/or flammable liquids are used or stored. Keep unit away from heated surfaces and open flames.
13. Avoid the use of an extension cord because the extension cord may overheat and cause a risk of fire. However, if you have to use an extension cord, the cord shall be No. 16 AWG minimum size and rated not less than 1500W.
14. To avoid fire or shock hazard, plug the unit directly into a 115 V AC electrical outlet.
15. To disconnect heater, turn controls to OFF, then remove plug from outlet. Pull firmly on the plug, DO NOT unplug by pulling on the cord.
16. Always unplug the unit before moving or cleaning, or whenever the heater is not in use.
17. Use only for intended household use as described in this manual. Any other use not recommended by the manufacturer may cause fire, electric shock, or injury to persons. The use of attachments not recommended or sold by unauthorized dealers may cause hazards.
18. Always use on a dry, level surface. Use on floor only.
19. DO NOT use outdoors.
20. WARNING: To reduce the risk of fire or electric shock, DO NOT use this unit with any solid-state speed control device.
21. DO NOT attempt to repair or adjust any electrical or mechanical functions on this unit. Doing so will void your warranty. The inside of the unit contains no user serviceable parts. Qualified personnel should perform all servicing only.
22. Connect to properly grounded outlets only.

### 23.SAVE THESE INSTRUCTIONS.

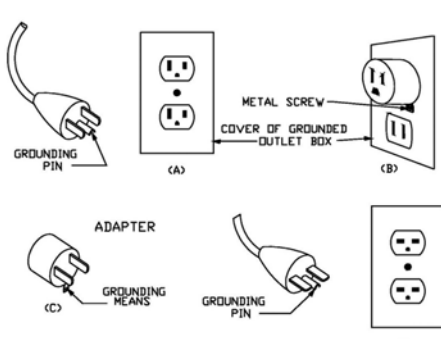

The diagram illustrates four electrical plug configurations labeled (A) through (D). (A) shows a standard three-prong grounded plug with a 'GROUNDING PIN' label. (B) shows a three-prong plug inserted into a two-slot outlet, with a 'METAL SCREW' on the side and a 'COVER OF GROUNDED OUTLET BOX' label. (C) shows a 'GROUNDING MEANS' adapter with a 'GROUNDING PIN' label. (D) shows a three-slot grounded receptacle.

**WARNING:** This heater has a voltage rating of 120 volts. The cord has a plug as shown in A. An adapter as shown in C is available for connecting three-blade grounding-type plugs to two-slot receptacles. The grounding lug extending from the adapter must be connected to a permanent ground such as a properly grounded outlet box. The adapter should not be used if a three-slot grounded receptacle is available.

**DO NOT DEFEAT THE SAFETY PURPOSE OF THE GROUNDED PLUG.**

## SPECIFICATIONS

Voltage Rating	120 V (60Hz)
Power Consumption	500/1000W
Unit Size	18 in. (W) x 8 5/8 in. (D) x 26 in. (H)
Unit Weight	8.8 lbs

## PRODUCT DIAGRAM

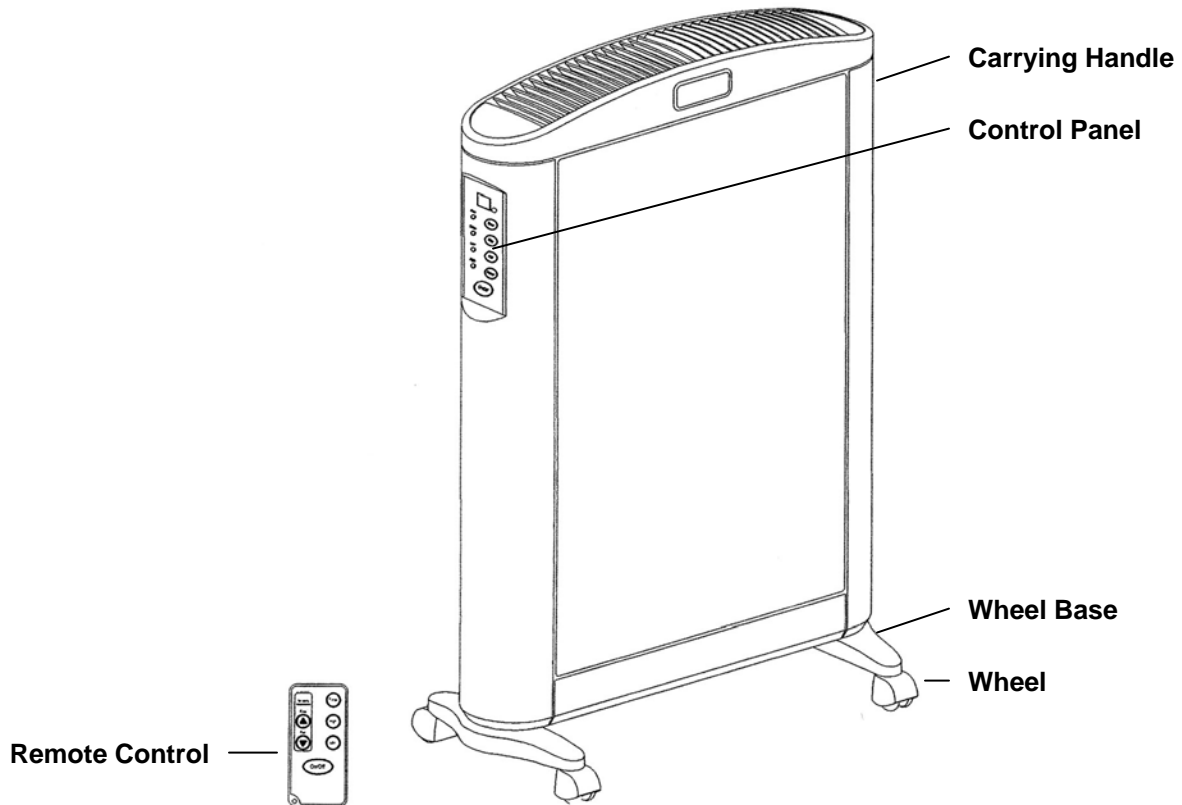

## ASSEMBLY

1. Remove the heater body, two wheelbases, wheels, screws, and washers from the box. Remove the packaging materials and keep for future storage.
2. Attach the wheels to each wheelbase with the supplied wheel screws, small black spring-washers, and small grey washers.

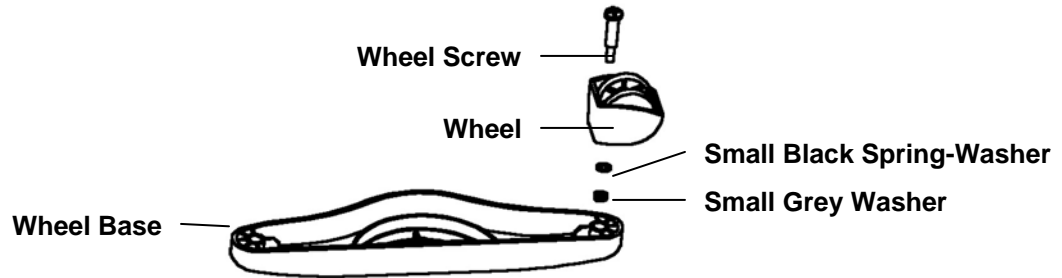

3. Be certain the heater is unplugged and the controls are set to off. Set the heater on the floor upside down.
4. Attach a wheel base (with wheels attached) to each end of the heater body using the supplied standard screws, large black spring-washers, and large grey washers.

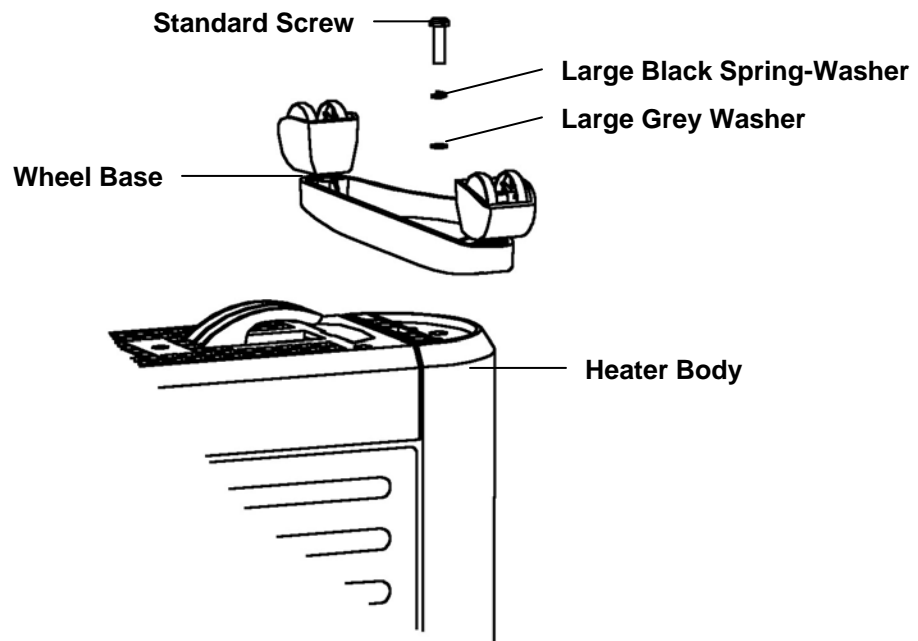

## OPERATING INSTRUCTIONS

Place the heater on a firm, level surface and plug into a grounded 120V 60Hz power outlet. Only operate heater in upright position with caster wheels attached.

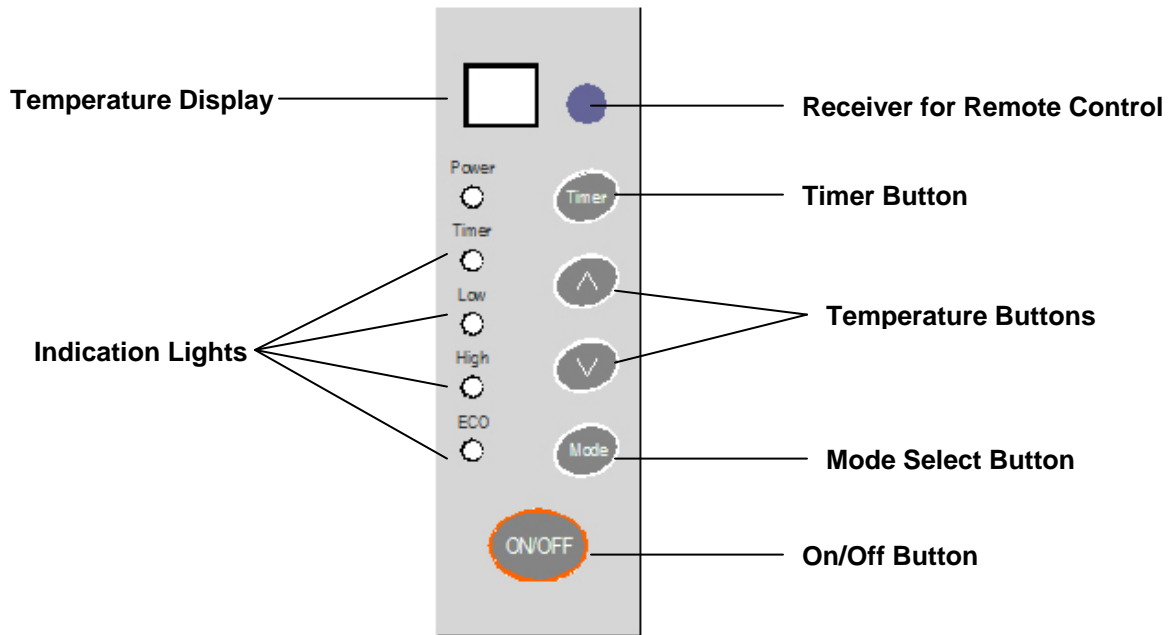

1. Turn the heater on by pressing the On/Off button on the control panel or the supplied remote control.
2. Select a heat setting.  
Press the MODE button to toggle between the three heat settings; LOW (500W), HIGH (1000W) and ECO mode. When using the remote control press either MODE button to select the preferred power setting.

**NOTE:** ECO mode is an Economic Energy Saving Function. When ECO mode is chosen the heater will consume one-third less power once the room temperature reaches a certain point.

3. Adjust the thermostat by pressing the arrows on the control panel or remote control. The digital readout will display the selected temperature.
4. Once you have chosen the desired temperature, the heater will remain on until the room temperature increases to the temperature on the digital display. The heater will cycle on and off to maintain the desired room temperature.
5. This heater is equipped with a 12-hour automatic shut-off timer. To activate the timer, press the TIMER button on the control panel or remote control. Each press of the timer button will increase the heater operating time by one hour. The digital readout will display the number of hours you have selected. To turn off the timer, simply press the TIMER button until the digital readout displays your current selected temperature.

6. The indication lights on the control panel communicate how the product is operating. The POWER light will turn-on when the unit is operating. The TIMER light will turn on when the timer has been activated. When choosing between High, Low, and ECO modes the corresponding lights will turn on according to the mode that has been selected.
7. Unplug the heater when not in use.

**NOTE:** For safety, if the heater's internal temperature rises above a certain point, the heater is designed to automatically shut off. To restart the heater in this situation:

1. Turn the Heater off by pressing the On/Off button.
2. Unplug the power cord from the outlet and allow the heater to cool for at least 10 minutes.
3. Plug the power cord back into the outlet and select the desired heat setting.

**WARNING:** It is normal for the power cord to feel warm to the touch; however, a loose fit between the outlet and the plug may cause overheating of the plug. If this occurs, try inserting the plug into a different outlet. Contact a qualified electrician to inspect the original outlet for damage.

## **MAINTENANCE**

1. Unplug the unit and let it cool completely.
2. To keep the heater clean, the outer shell may be cleaned with a soft, damp cloth. You may use a mild detergent if necessary. After cleaning, dry the unit with a soft cloth.  
CAUTION: DO NOT let liquid enter the heater.
3. DO NOT use alcohol, gasoline, abrasive powders, furniture polish, or rough brushes to clean the heater. This may cause damage or deterioration to the surface of the heater.
4. DO NOT immerse the heater in water.
5. Wait until the unit is completely dry before use.

## **STORAGE**

Store the heater in a cool, dry location when not in use. To prevent dust and dirt build-up, use the original packaging to repack the unit.

## **TROUBLESHOOTING**

If the heater will not operate, please check the following before seeking repair of service:

1. Check if the power cord is plugged into an electrical outlet, if not, plug in.
2. Check if electricity to the main fuse is working.
3. Make certain the unit is turned on, and either the HIGH, LOW, or ECO mode is selected.  
If not, turn the heater on and choose a setting.

NOTE: The heater may not be operating if the thermostat is set higher than the room temperature. To begin operation, increase the thermostat temperature for a higher heat setting.



## **WARRANTY**

### **One Year Limited Warranty**

Soleus International Inc. warrants the accompanying Soleus Air HM1-10R-32 to be free of defects in material and workmanship for the applications specified in its operation instruction for a period of ONE (1) year from the date of original retail purchase in the United States.

If the unit exhibits a defect in normal use, Soleus International Inc. will, at its option, either repair or replace it, free of charge within a reasonable time after the unit is returned during the warranty period.

As a condition to any warranty service obligation, the consumer must present this Warranty Certificate along with a copy of the original purchase invoice.

#### **THIS WARRANTY DOES NOT COVER:**

- 1) Damage, accidental or otherwise, to the unit while in the possession of a consumer not caused by a defect in material or workmanship.
- 2) Damage caused by consumer misuse, tampering, or failure to follow the care and special handling provisions in the instructions.
- 3) Damage to the finish of the case, or other appearance parts caused by wear.
- 4) Damage caused by repairs or alterations of the unit by anyone other than those authorized by Soleus International Inc.
- 5) Freight and Insurance cost for the warranty service.

ALL WARRANTIES, INCLUDING ANY IMPLIED WARRANTY OF MERCHANT ABILITY ARE LIMITED TO ONE-YEAR DURATION OF THIS EXPRESS LIMITED WARRANTY. **SOLEUS INTERNATIONAL INC.** DISCLAIMS ANY LIABILITY FOR CONSEQUENTIAL OR INCIDENTAL DAMAGES AND IN NO EVENT SHALL SOLEUS INTERNATIONAL INC'S LIABILITY EXCEED THE RETAIL VALUE OF THE UNIT FOR BREACH OF ANY WRITTEN OR IMPLIED WARRANTY WITH RESPECT TO THIS UNIT.

This warranty covers only new products purchased from our authorized dealers or retailers. It does not cover used, salvaged, or refurbished products.

As some states do not allow the limitation or exclusion of incidental or consequential damages, or do not allow limitation on implied warranties, the above limitations and exclusions may not apply to you. This warranty gives you specific legal rights, and you may also have other rights that vary from state to state.

#### **For Technical Support and Warranty Service**

Please Call (888) 876-5387

Or Write To:

Soleus International Inc.

9451 Telstar Ave.

El Monte, CA 91731 USA

[www.soleusair.com](http://www.soleusair.com)